

LEGEND

	SITE BOUNDARY		DATASHEET LOCATION/NUMBER (NOT SURVEYED)
	JURISDICTIONAL WETLAND AREAS		RCP REINFORCED CONCRETE PIPE
	APPROXIMATE LIMITS OF PERENNIAL STREAM (PER WSSI'S OBSERVATIONS - NOT SURVEYED)		IRON PIPE FOUND
	EPHEMERAL STREAM (PER WSSI'S OBSERVATIONS)		TRAVERSE STATION FOUND
	WETLAND FLAGGING POINT/NUMBER (pink-glo)		FLY POINT (WSSI)
	DATA SHEET LOCATION/NUMBER		

SUMMARY OF JURISDICTIONAL AREAS WITHIN THE LOG INN PROPERTY*

COWARDIN CLASSIFICATION	AREA		LINEAR FEET OF STREAMBED
	(SQUARE FEET)	(ACRE)	
R3	21,230	0.49	1,097
RE	2,429	0.06	469
PFO	561,058	12.88	N/A
TOTAL	584,717	13.43	1,566

* These numbers are based on the surveyed and approximate location(s) of the delineated WOTUS boundaries within the study area boundary.

COWARDIN CLASSIFICATION

PFO	PALUSTRINE FORESTED WETLAND
R3	RIVERINE UPPER PERENNIAL
RE	RIVERINE EPHEMERAL

WATERS OF THE U.S. DELINEATION AND SURVEY NOTES:

- This map has been oriented to The Maryland Coordinate System of 1983, North Zone, using real time DGPS. Wetlands and other Waters of the U.S. (i.e. streams) flags, data points, and the monumentation shown were located in the field using conventional survey methods. Accuracy of field locations of wetlands meets or exceeds the standards set by the U.S. Army Corps of Engineers Memo CENAO-CO-R, dated September 30, 1998. Field locations were completed on February 14, 2017.
- The boundary line information shown hereon is for information purposes only and does not constitute a boundary survey by WSSI. Monumentation, including traverse stations and fly points, shown on this drawing should be used to orient wetland locations to any future boundary, topographic, or location survey.
- Periodic flag numbers are shown on this drawing depicting the survey-located boundary of wetlands and other waters of the U.S. (i.e., streams, ponds, etc.). Waters of the U.S. flags are pink-glo in color. Data points are flagged with orange-glo and pink-glo flagging tied together.
- Topo/boundary information obtained in digital format from Anne Arundel County digital data was used as a base for this Plan.
- This delineation was performed pursuant to the "Corps of Engineers Wetlands Delineation Manual," Technical Report Y-87-1 (1987 Manual) and subsequent guidance and modification by the *Regional Supplement to the Corps of Engineers Wetland Delineation Manual: Atlantic Gulf and Coastal Plain Region (Version 2.0)* dated November 2010.
- The Routine On-Site Wetland Determination Method for sites more than 5 acres was used for this site, with multiple transects performed as depicted on this Attachment.
- Field work was performed on January 29, 30, and 31 2017 by Michael J. Klebasco, Kenneth A. Wallis, Audrey McTaggart, and Brianna Beauchamp.
- The terms "Ephemeral", "Intermittent", and "Perennial" used on this Plan classify and describe the flow regime character of streams, are based on WSSI's field observations, and are only provided for state and local regulatory purposes. The flow regimes of streams are not verified by the COE; however, the geographic limits of these streams are all subject to COE jurisdiction, and the COE's approval of this delineation represents only the approval of the geographic limits of waters of the U.S.
- WSSI has delineated and surveyed the outer limits of jurisdictional areas within the project site. One of the jurisdictional areas on the site is composed of systems containing different wetland and stream (i.e., R3 and RE) types. The approximate limits of the different wetland and stream types within the surveyed jurisdictional areas are depicted as a thin black line of the associated line type.
- Wetland limits between Flags C13 and C21C are approximated and have been added to the plan at the request of Lisa Dosmann of the Maryland Department of the Environment during a site visit on September 19, 2017.

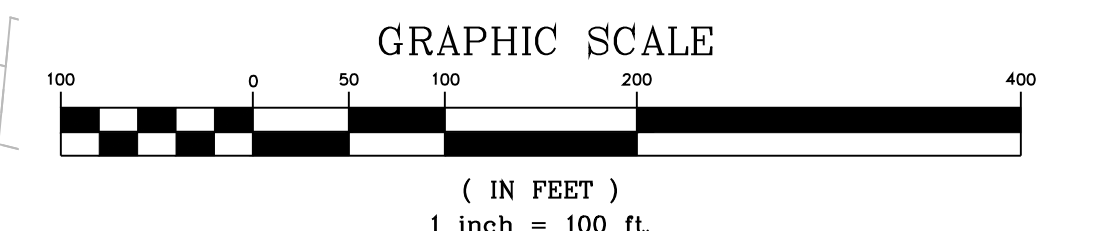
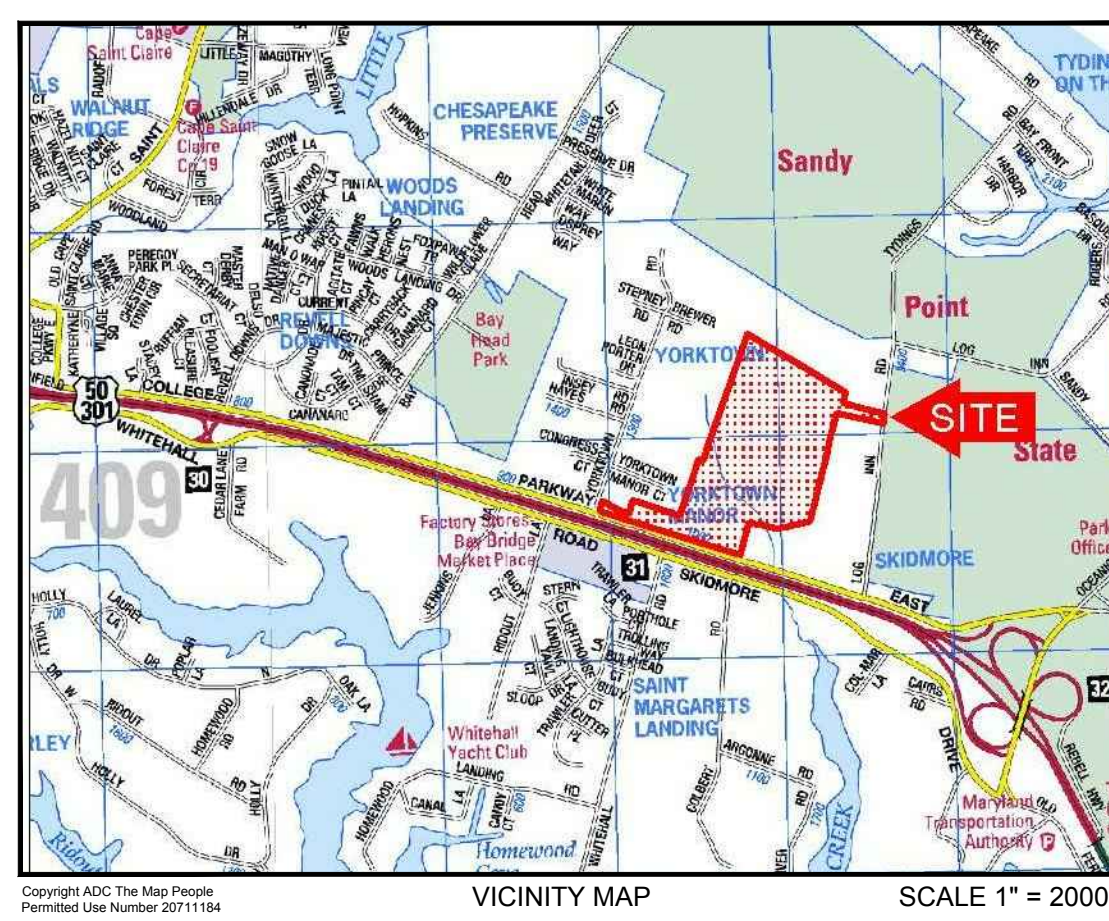
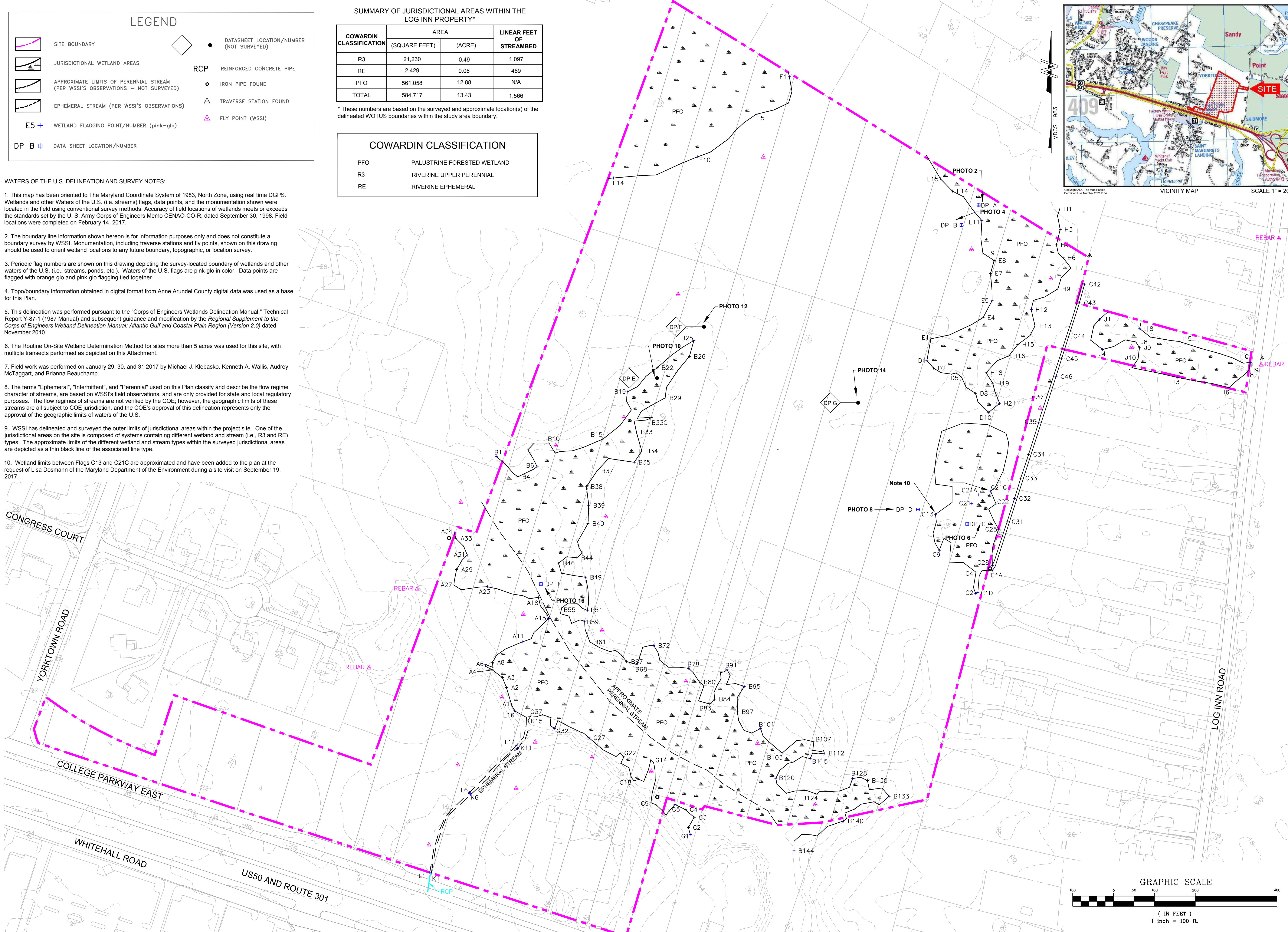

company
at
DMET

1131 Renfield Boulevard • Suite L
Millersville, Maryland 21108
Phone: 410-672-5990 • Fax: 410-672-5993
www.wetlandstudies.com

Wetland Delineation Plan

Prepared for: The Adler Corporation
Log Inn Road Property
Anne Arundel County
Copyright © 2017 Wetland Studies and Solutions, Inc.

REVISIONS		App. By	By
No.	Date	Description	

DATE: March 7, 2017
SCALE: 1" = 100'

Horizontal Datum: MGS NAD 83
Vertical Datum: NAVD 1988
Boundary and Topo Source:
Anne Arundel County Digital Data

Design	Draft	Approved
EJC	LI	MJK

Sheet #
1 of 1

Computer File Name:
E:\Maryland\Projects\MD010000\MD010000\MD010000.dwg